

Push Button Switch PB-1830 Series

SPECIFICATIONS

1. Circuit: Push on and non lock
2. Rating: 1A, 125VAC.
3. Contact resistance: 5VDC 1A 30mΩ Max.
4. Insulation resistance: 500VDC 100MΩ Min
5. Withstand voltage: 500VAC 1 minute
6. Operating force: 250±50g
7. Life cycle: 40,000 cycles Max.

PART NUMBERING SYSTEM

{1} PB — {2} 1830 {3} {4} F

{1} Series: PB: Push button switch

{2} Model: 1830

{3} Color of button: B: Black, BL: Blue, G: Green, O: Orange, R: Red, W: White, Y: Yellow

{4} F: RoHS compliance

DIMENSIONS (Unit:mm)

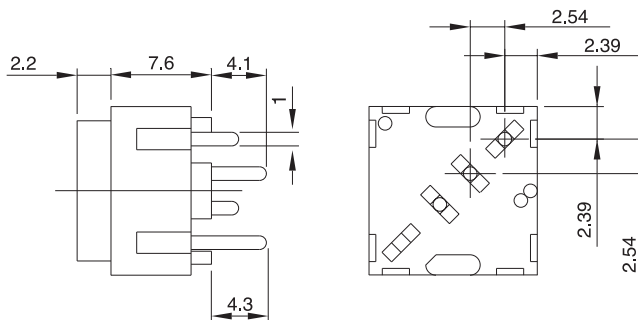
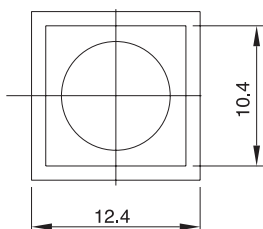

Push Button Switch PRL5-1 Series

SPECIFICATIONS

1. Rating: 10(4)A, 250VAC T125
16(6)A, 250VAC T125
2. Contact resistance: 20mΩ Max.
3. Insulation resistance: DC 500V 100MΩ Min.
4. Dielectric strength: 1,500VAC for 1 minute

PART NUMBERING SYSTEM

{1} PRL5-1 {2} {3} Button / Housing {4} F

{1} Series: PRL5-1: Push button switch

{2} Circuit:

A: 4P (ON)-OFF W/ Lamp D: 4P ON OFF-W/ Lamp

B: 4P (ON)-OFF E: 4P ON-OFF

C: 2P (ON)-OFF F: 2P ON-OFF

{3} Color: B: Black, G: Green, H: Gray, I: Ivory, R: Red, W: White, Y: Yellow

{4} F: RoHS compliance

DIMENSIONS (Unit:mm)

